

A.7.1.006_Spindsocket Umkleide Sauna_S1
M 1: 50

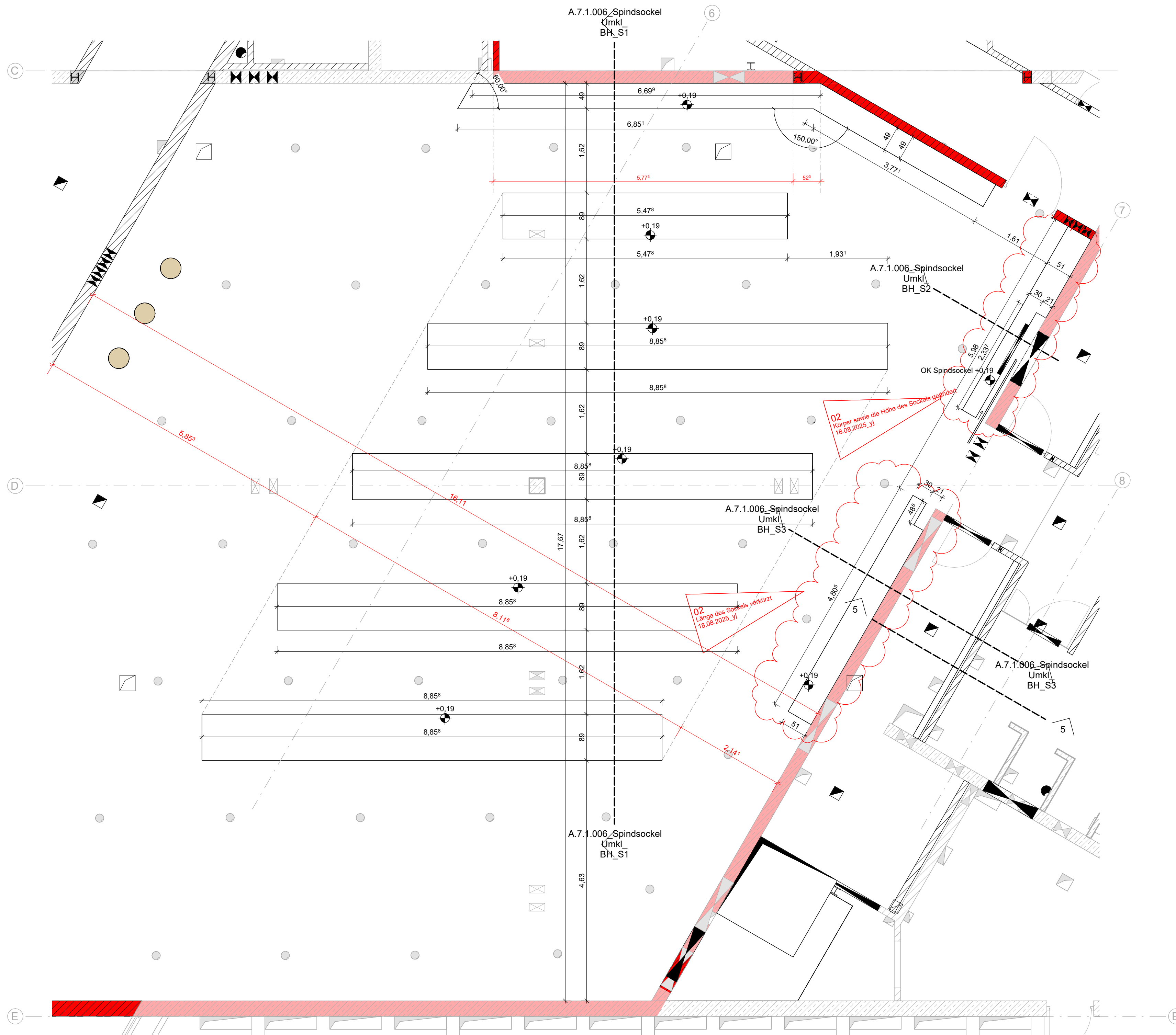

A.7.1.006_EG-Detailschnitt Spindsocket Umkleide BH
M 1: 50

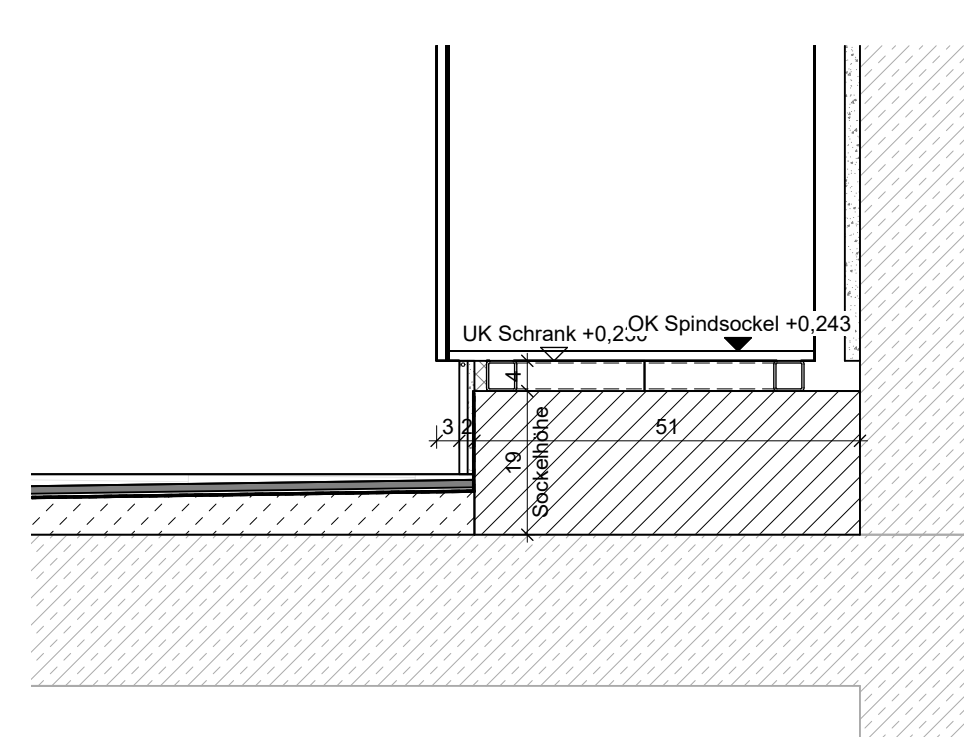

A.7.1.006_Spindsocket Umkl_BH_S3
M 1: 10

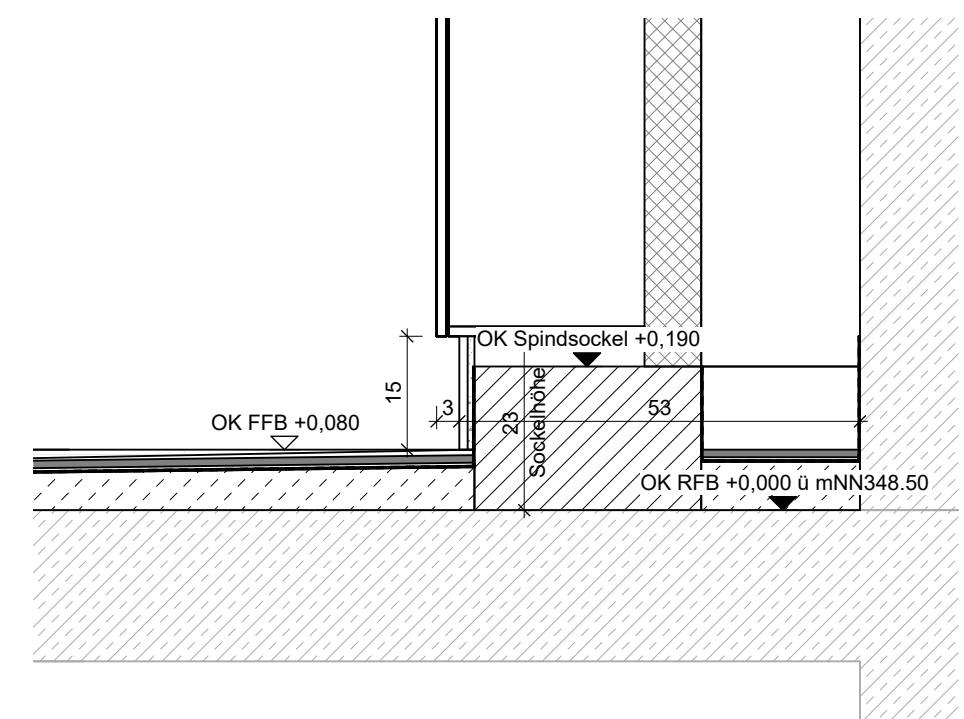

A.7.1.006_Spindsocket Umkl_BH_S2
M 1: 10

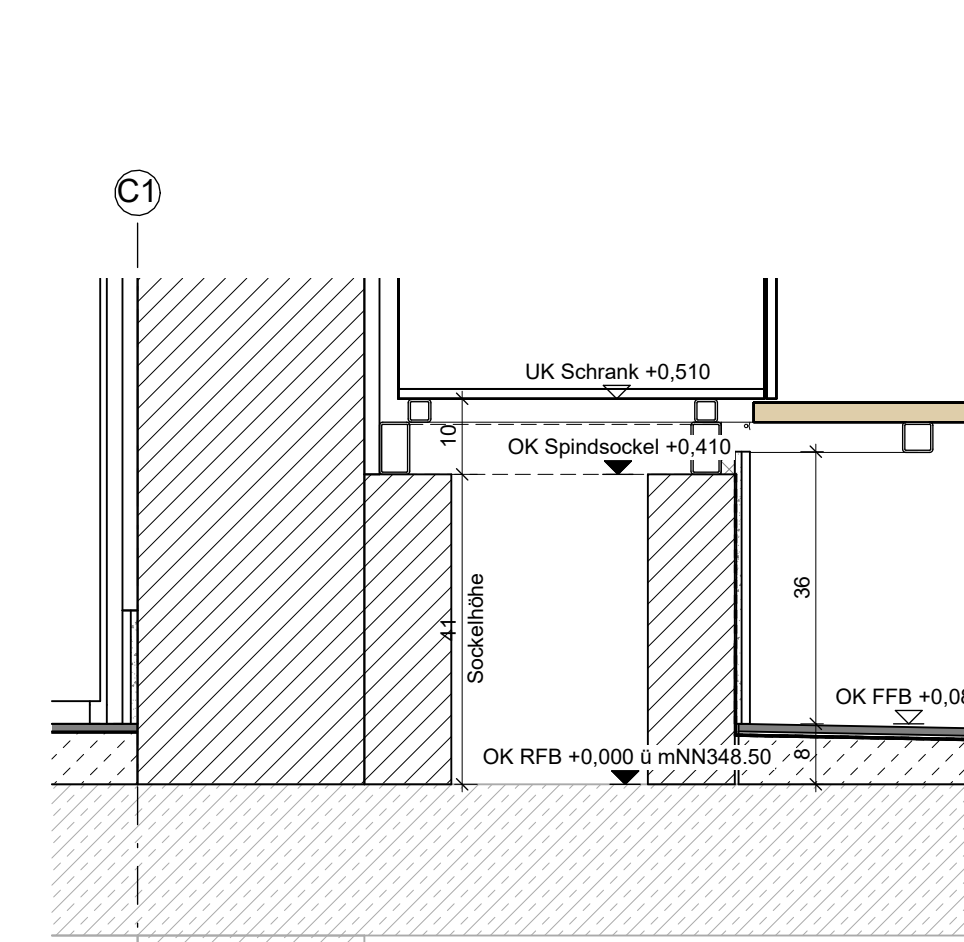

A.7.1.006_Spindsocket Umkl_Sauna_S3
M 1: 10

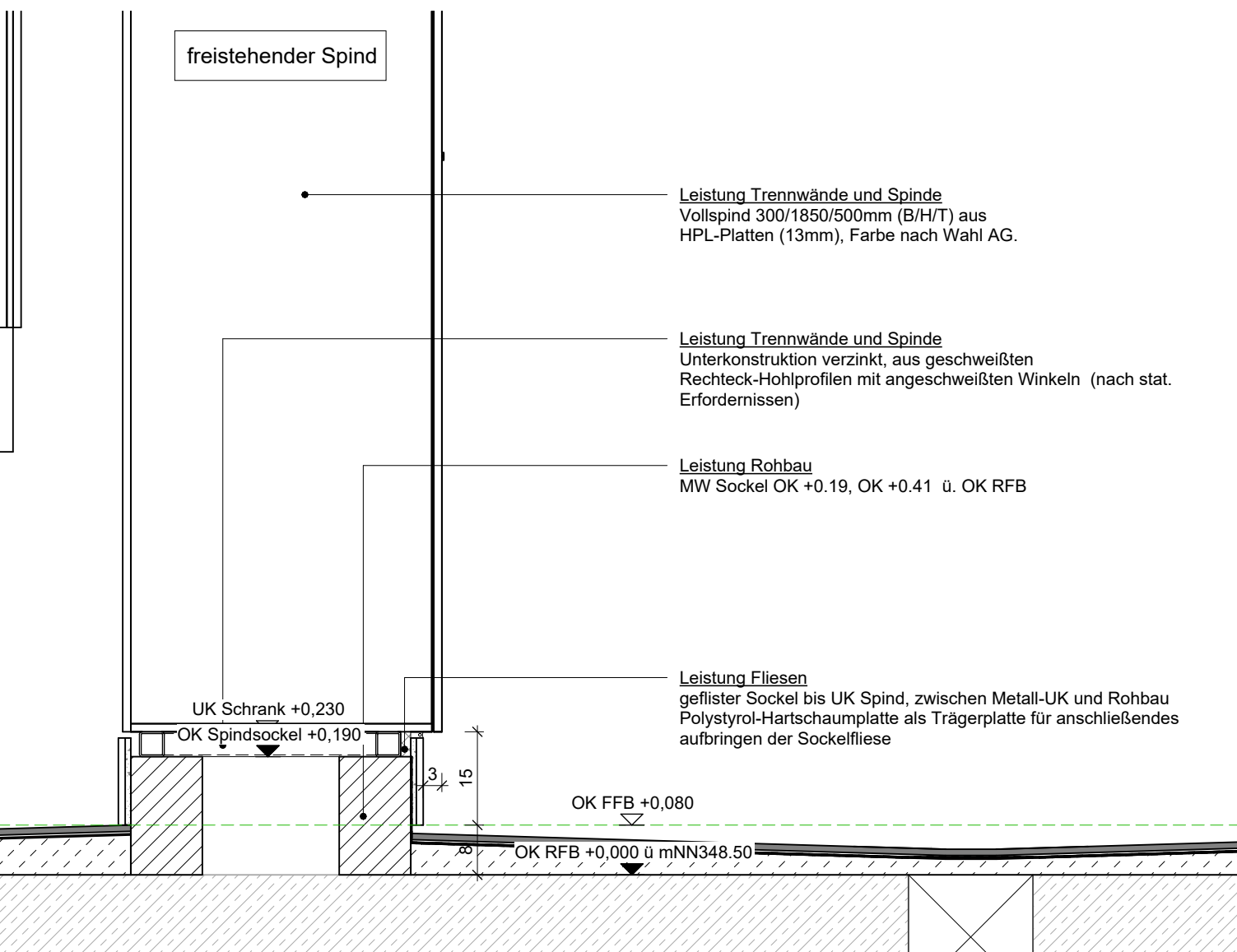

A.7.1.006_Spindsocket Umkl_Sauna_S1
M 1: 10

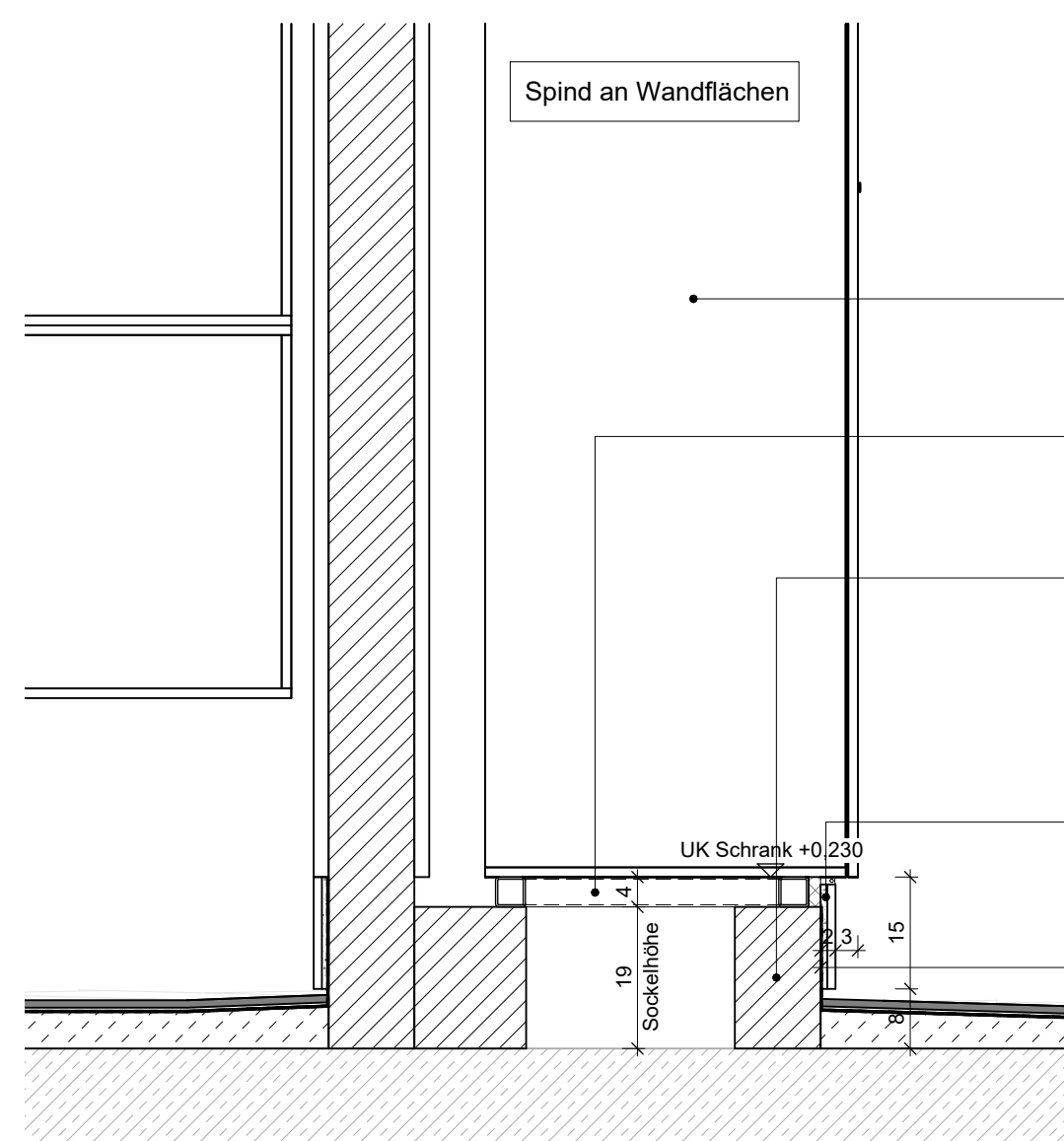
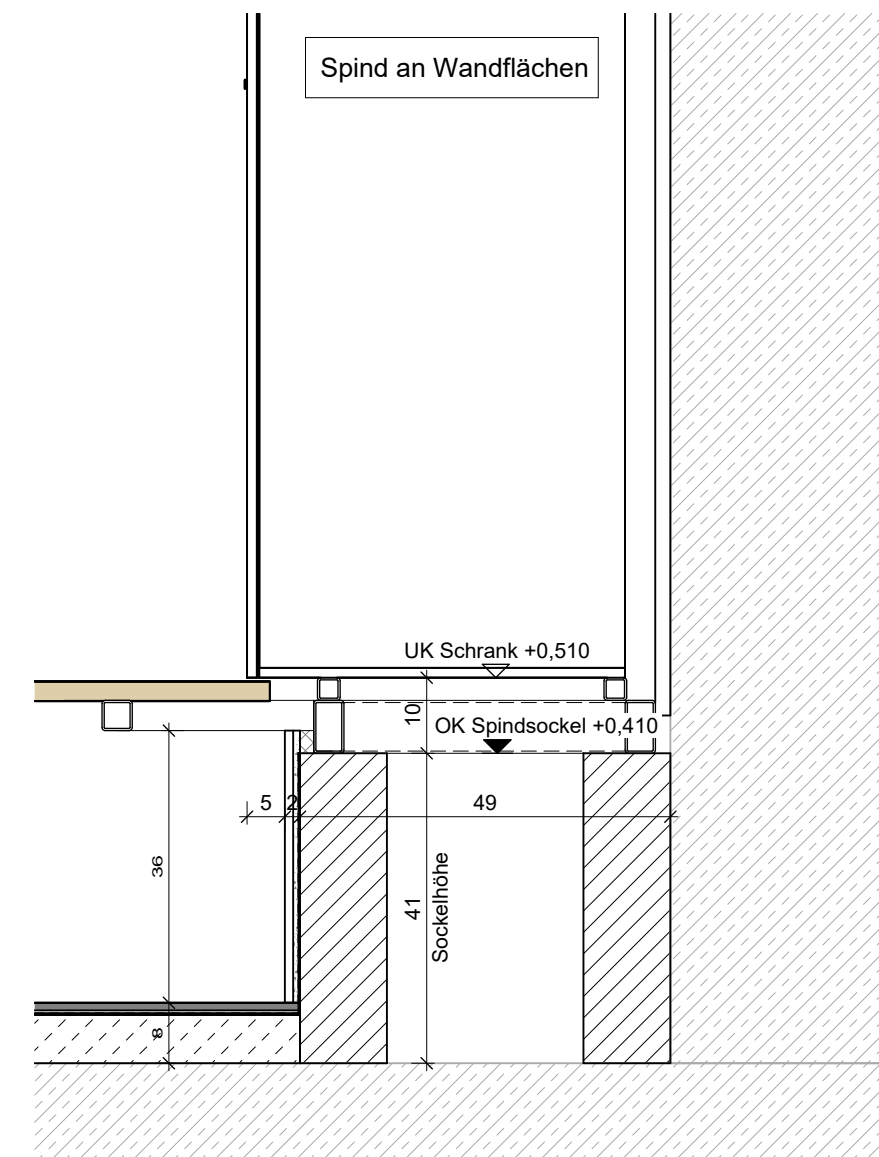
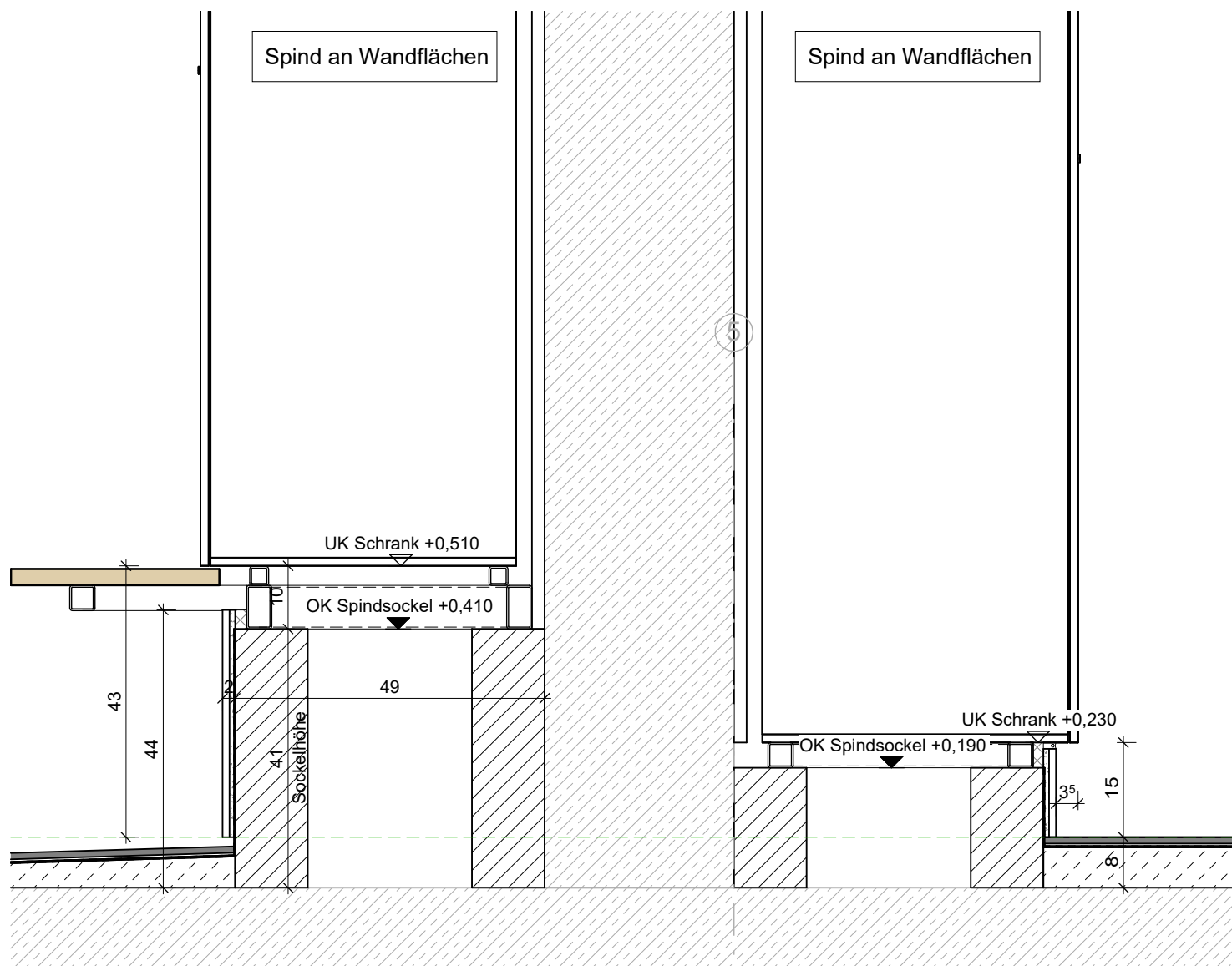

A.7.1.006_Spindsocket Umkl_Sauna_S2
M 1: 10

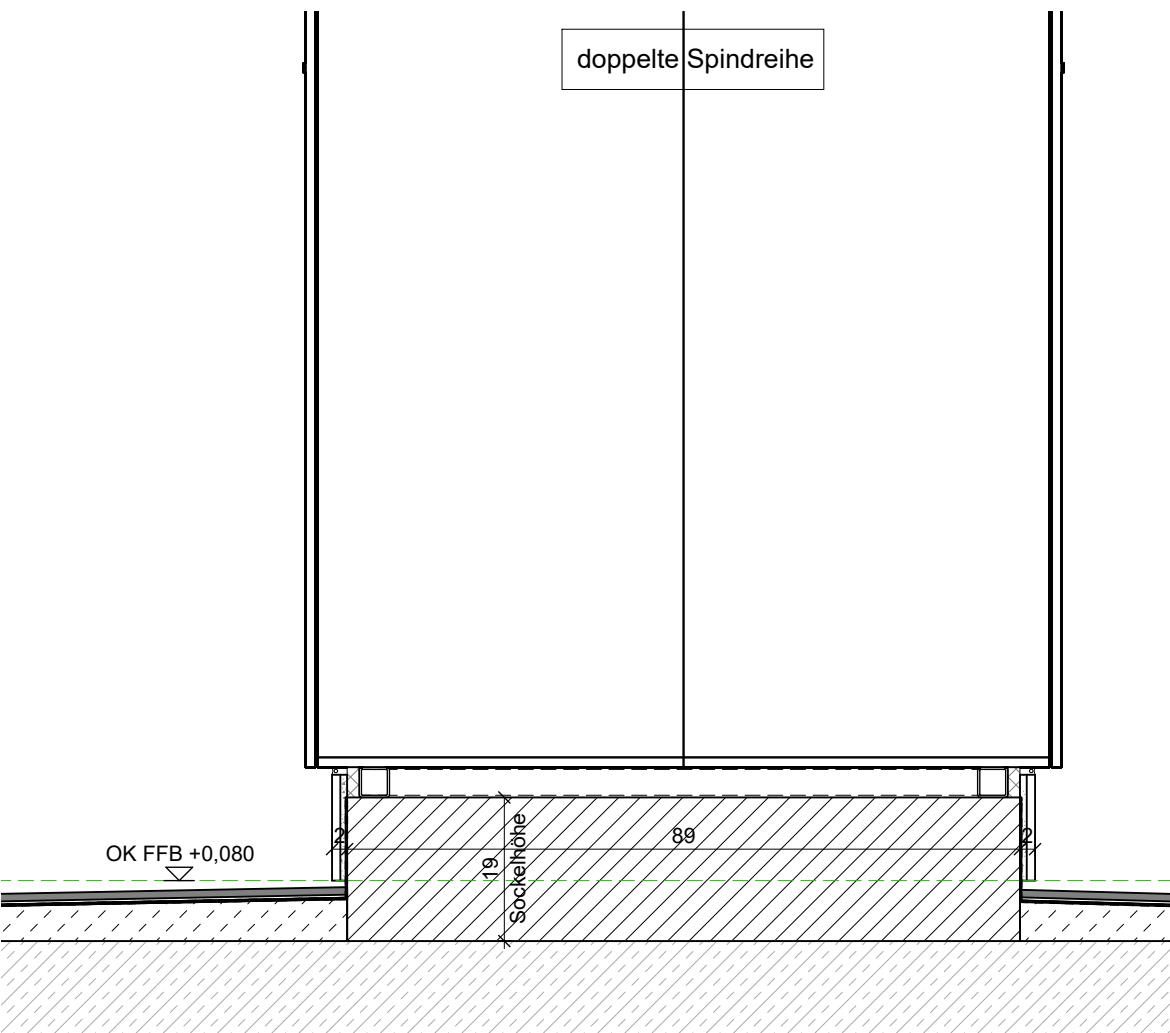
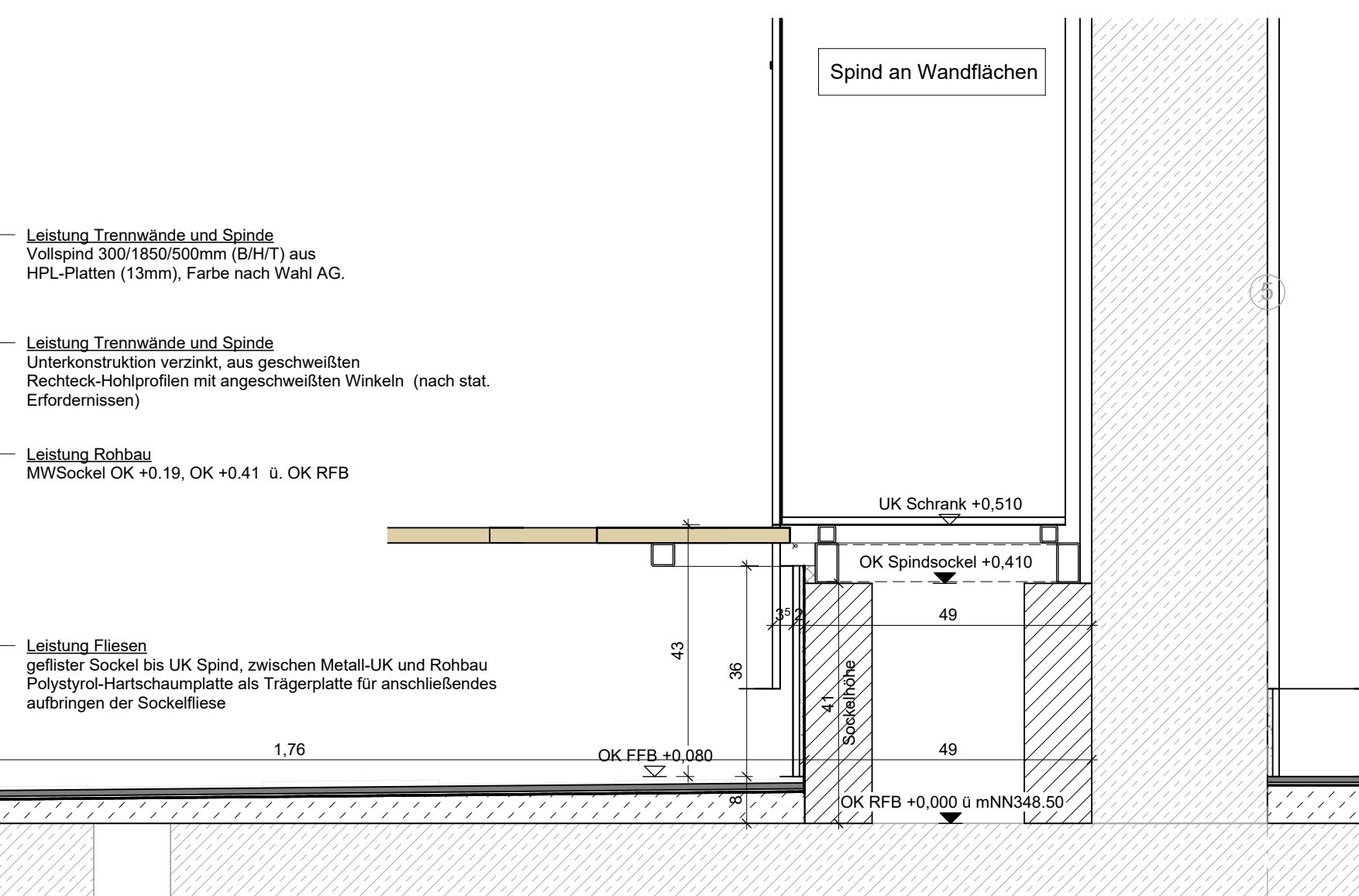

A.7.1.006_Spindsocket Umkl_BH_S1
M 1: 10

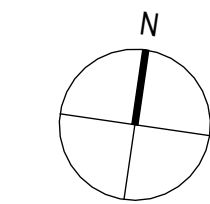
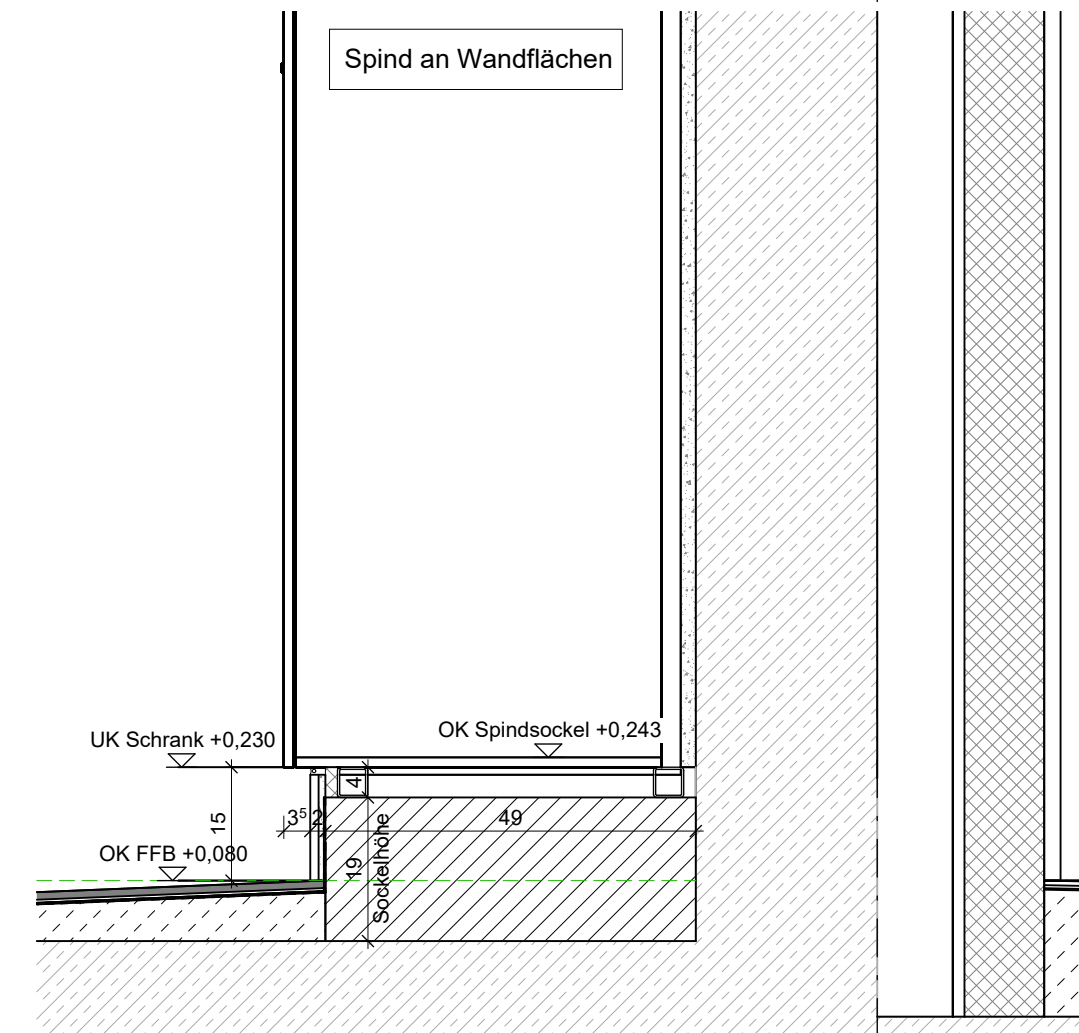
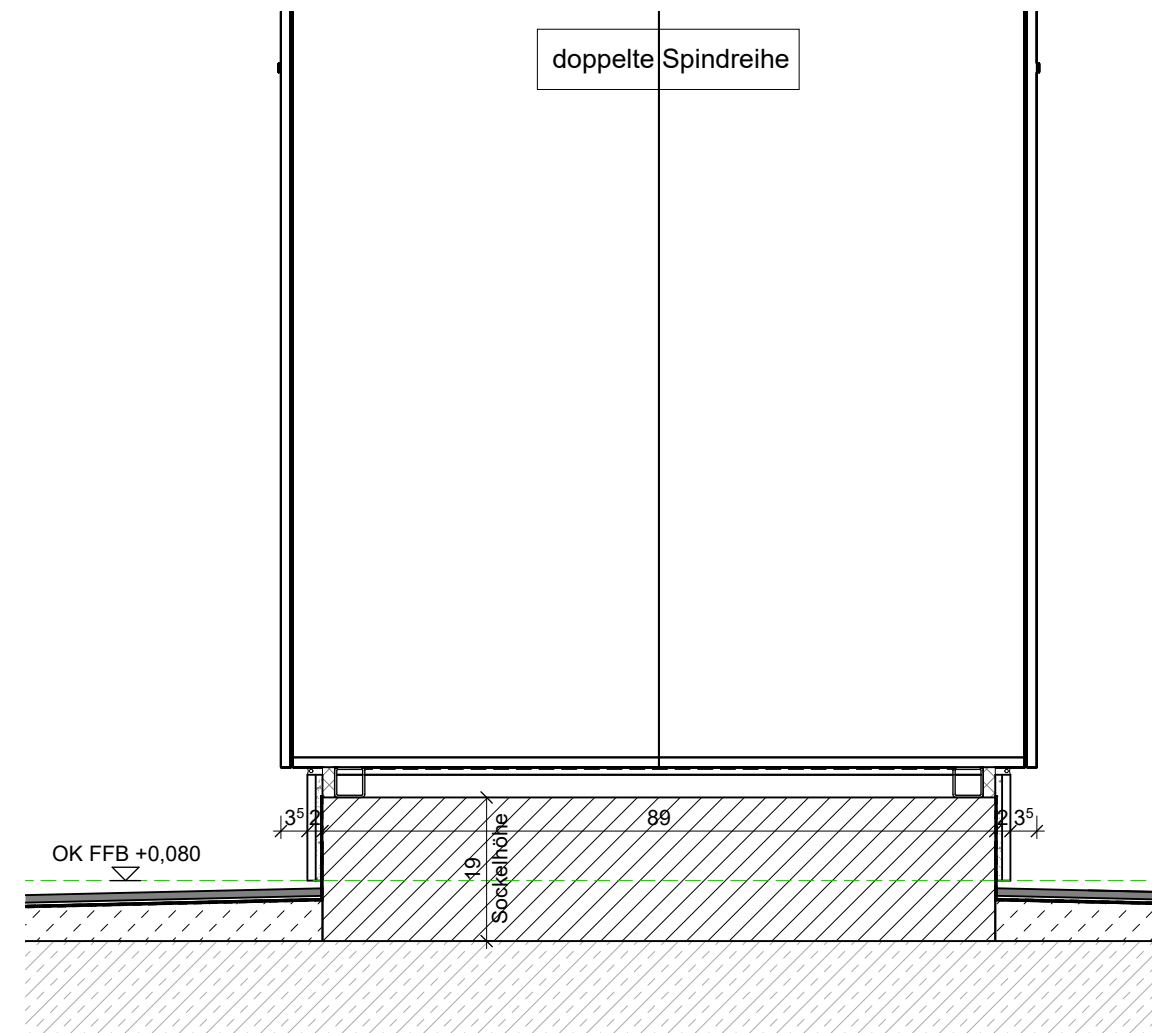
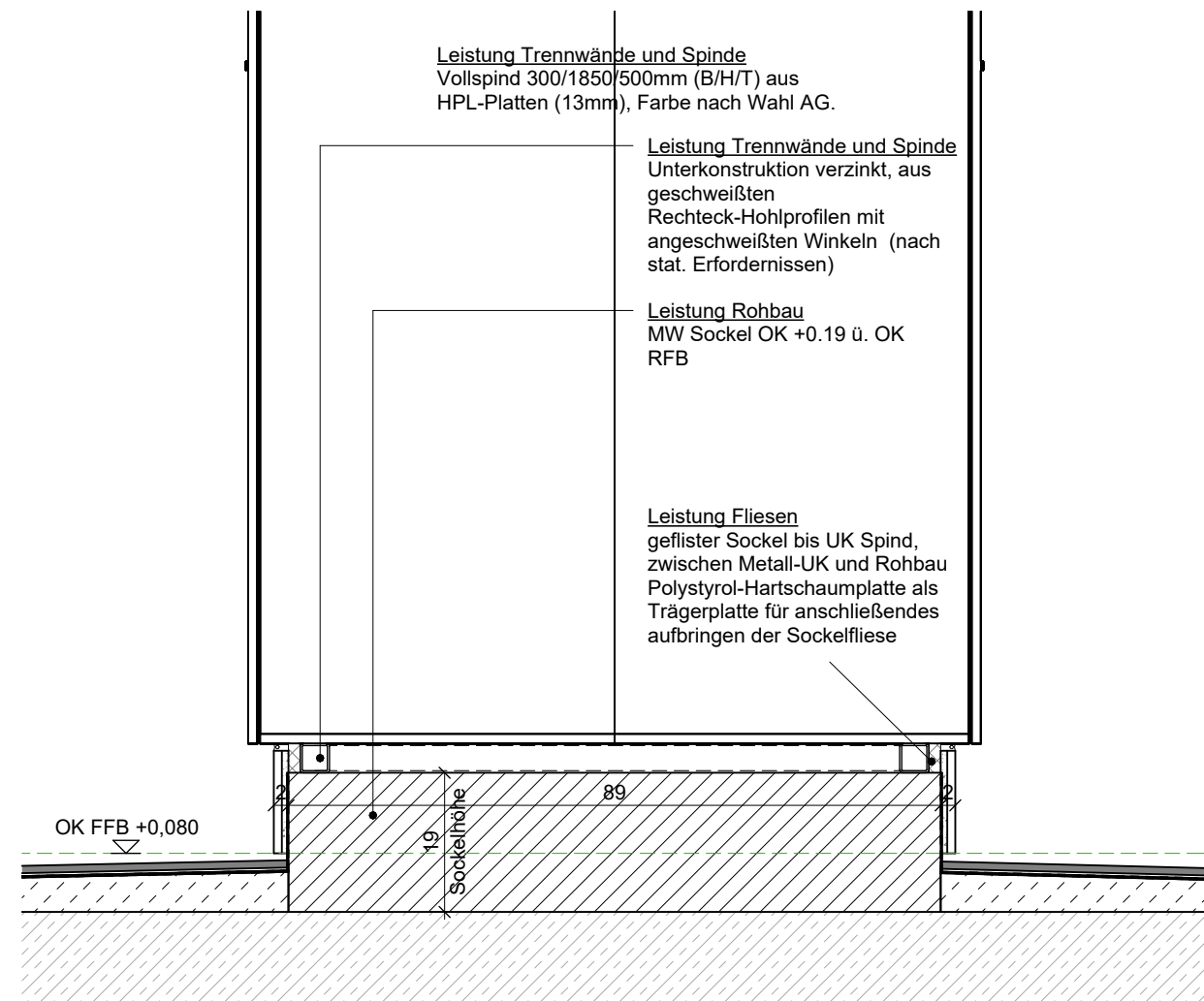
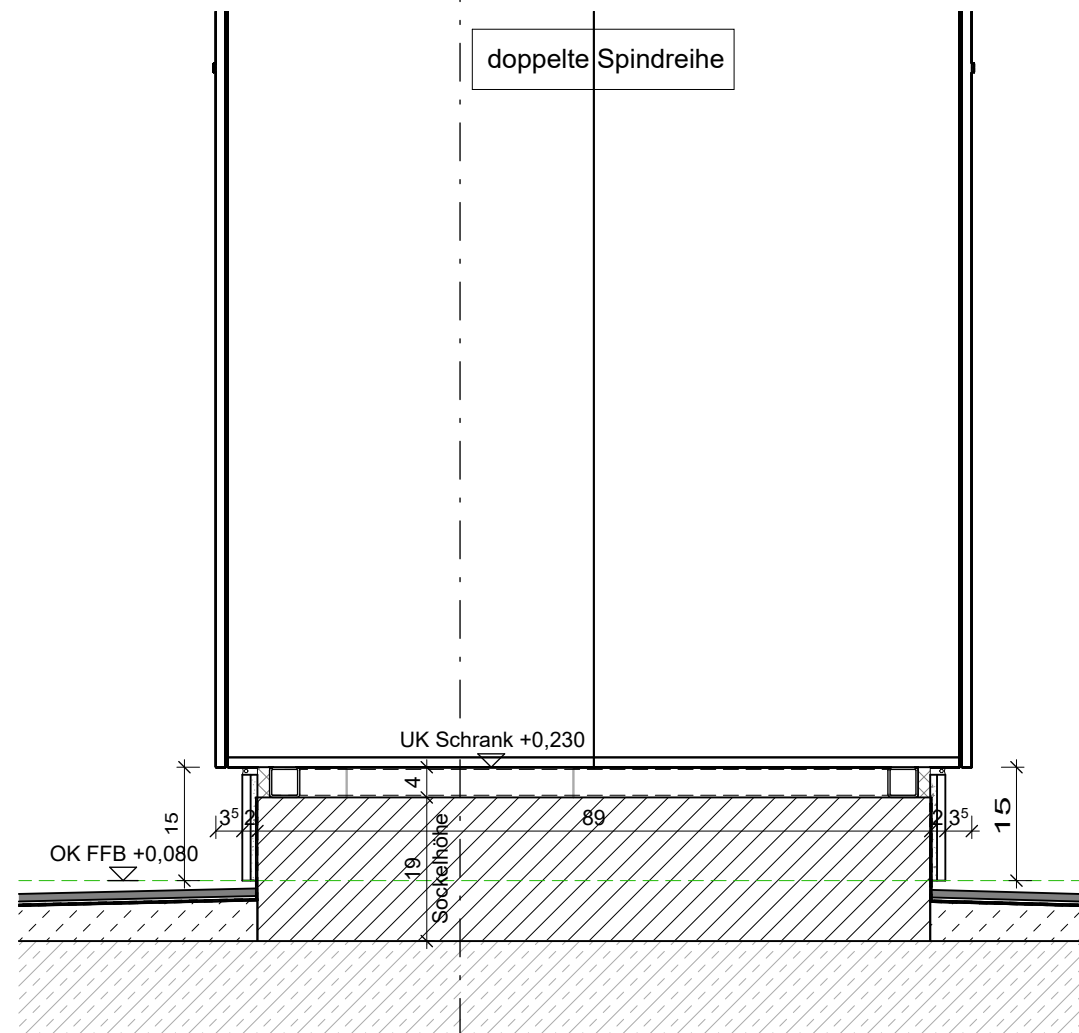
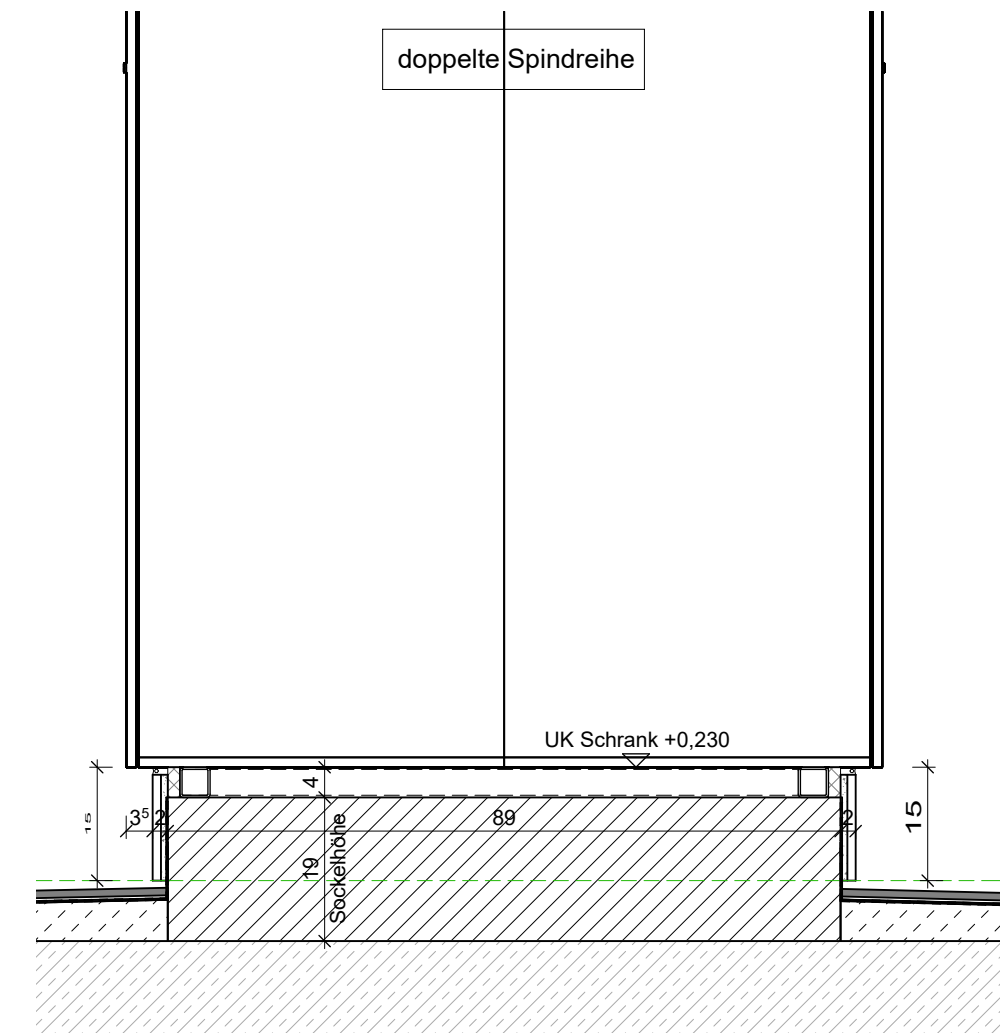

OK RFB = 0.000=348.50 m ü.NN

Ausführungsplanung

Projekt: Siebentälertherme Herrenalb

Bau teil: Spindsocket_BH_EG

Plan Nr.: A.7.1.006 Index: 02

Maßstab: 1:50 Datum: 15.07.2024

Größe: 1189 x 841 mm Gezeichnet: az

Bauherr: Stadtwerke Bad Herrenalb GmbH
Bahnhofstraße 12
76332 Bad Herrenalb

4a
4a Architekten GmbH
Heldstraße 25
70376 Stuttgart
www.4a-architekten.de - kontakt@4a-architekten.de
Telefon +49 711 3892005-0
Telefax +49 711 3892005-99